

016



Aviator[®]

SECRET FIX ROOF SYSTEM

PRODUCT DATA SHEET
REPORT NO: 016

REVISION NO: 002

PRODUCT CODE: SFB240

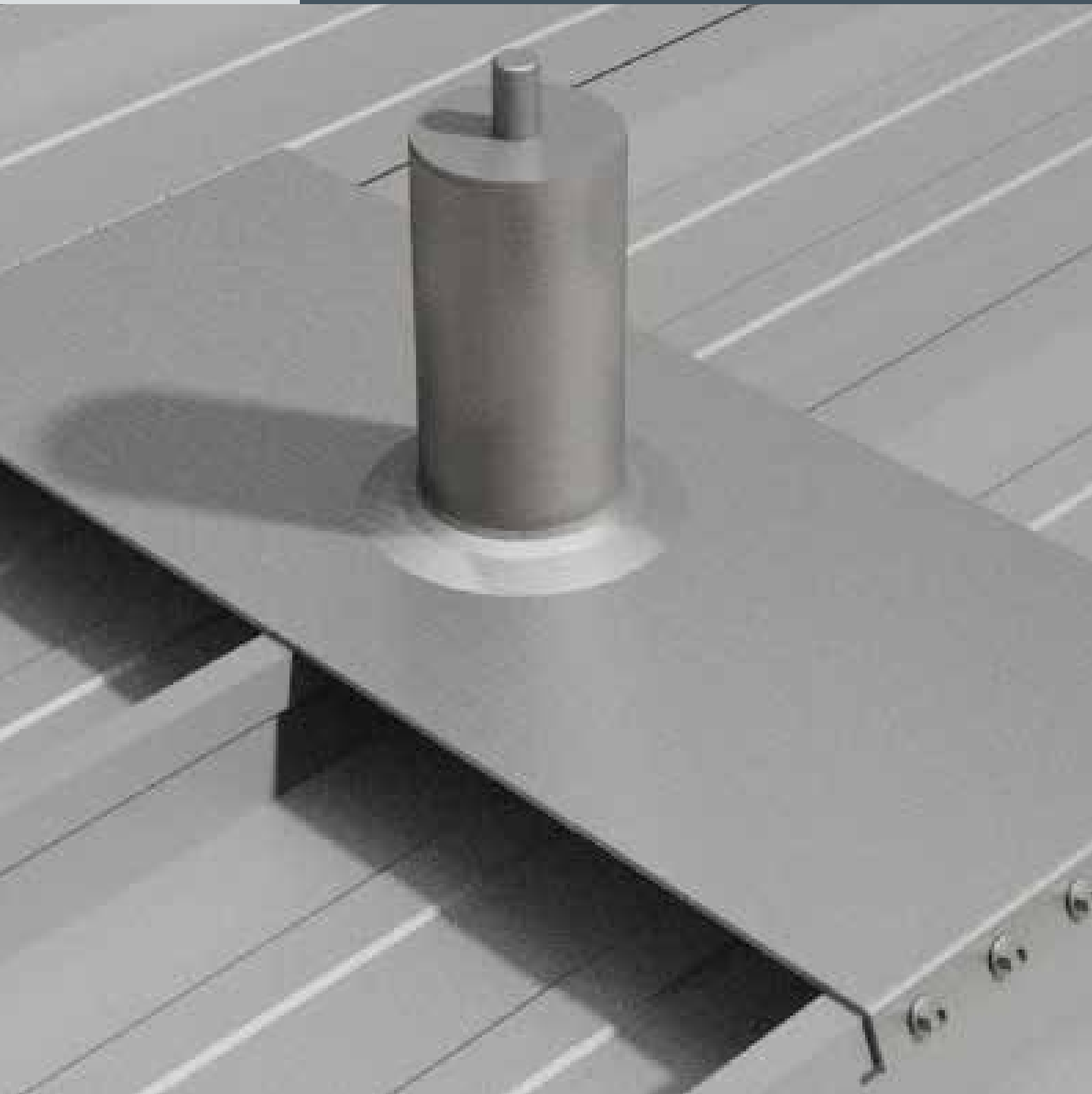

AVIATOR SECRET FIX ROOF SYSTEM



PRODUCT DESCRIPTION:

A safety line bracket system for installation on secret fix metal roof systems up to a 15 degree pitch. The brackets are installed onto the completed roof system with either Sayfa bulb type rivets or non-penetrating clamps that have an integrated neoprene seal. The brackets are installed with a sealing strip between the bracket and roof deck to ensure a leak proof installation. No additional sealing is required on completion of an installation. Both brackets and cable can be installed in a single visit. Brackets are manufactured in electro polished stainless steel to ensure long service life. Brackets are supplied in a standard length of 540mm with the mounting holes slotted to accommodate most leading makes of secret fix panels. Larger bespoke sizes can be manufactured on request.

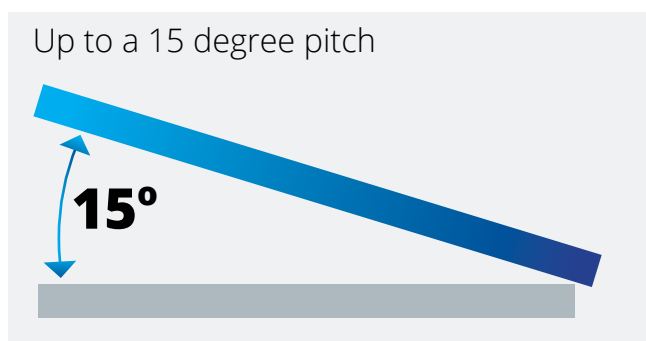

The safety line system is designed to operate as a fall restraint system or a fall arrest system depending on the layout design. All systems are fitted with an in-line shock absorber on the end brackets. When used together with a shock absorbing lanyard, the shock absorbing capabilities will ensure that no more than 4kN force is exerted on the users at any point in the system. We recommend only 2 user on a fall arrest system.



The fall restraint systems can be designed for up to 2 users at any one time and provide unrestricted access along the full length of the system. Corners and intermediate brackets allow the line shuttle to move smoothly along the full length of the cable between end brackets.



We recommend only one user on a fall arrest system

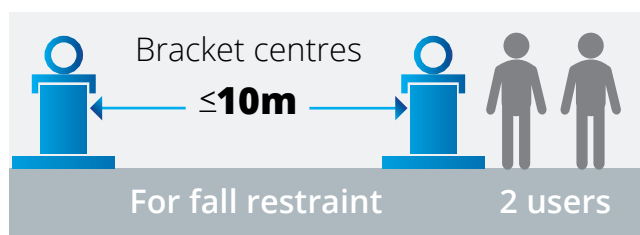

MATERIAL SPECIFICATION:

Brackets and component parts

Stainless Steel - Grade 304 (UNS S30400)
 Fe, <0.08% C, 17.5-20% Cr, 8-11% Ni, <2% Mn, <1% Si,
 <0.045% P, <0.03%
 Stainless Steel
 Surface elctropolished typically 20-40 micron case
 removal of stainless steel.

Rain cap

Polyvinyl Chloride-PVC. Tensile Strength 2.60 N/
 mm², Notched Impact Strength 2.0 - 45 Kj/m²,
 Thermal Coefficient of expansion 80×10^{-6} , Max
 Cont Use Temp 60 C, Density 1.38 g/cm³

Bulb type rivet

Aluminium body 0.50 - 0.75 Si, Max 0.35, Fe 0.40 - 0.70 Mg
 Tensile strength 151MPa
 Yield strength 89Mpa
 Neoprene seal Elastomer - Neoprene
 Colour - Black
 Quality - Commercial Grade - C20 Hardness - 65° Shore A +/-5°
 S.G. - 1.4G/Cm³ Tensile Mpa - 5 Min Elongation - 300%
 Tear Strength - 20 Kg/Cm Compression Set - 35%
 Operating Temperature -20° / +110° C

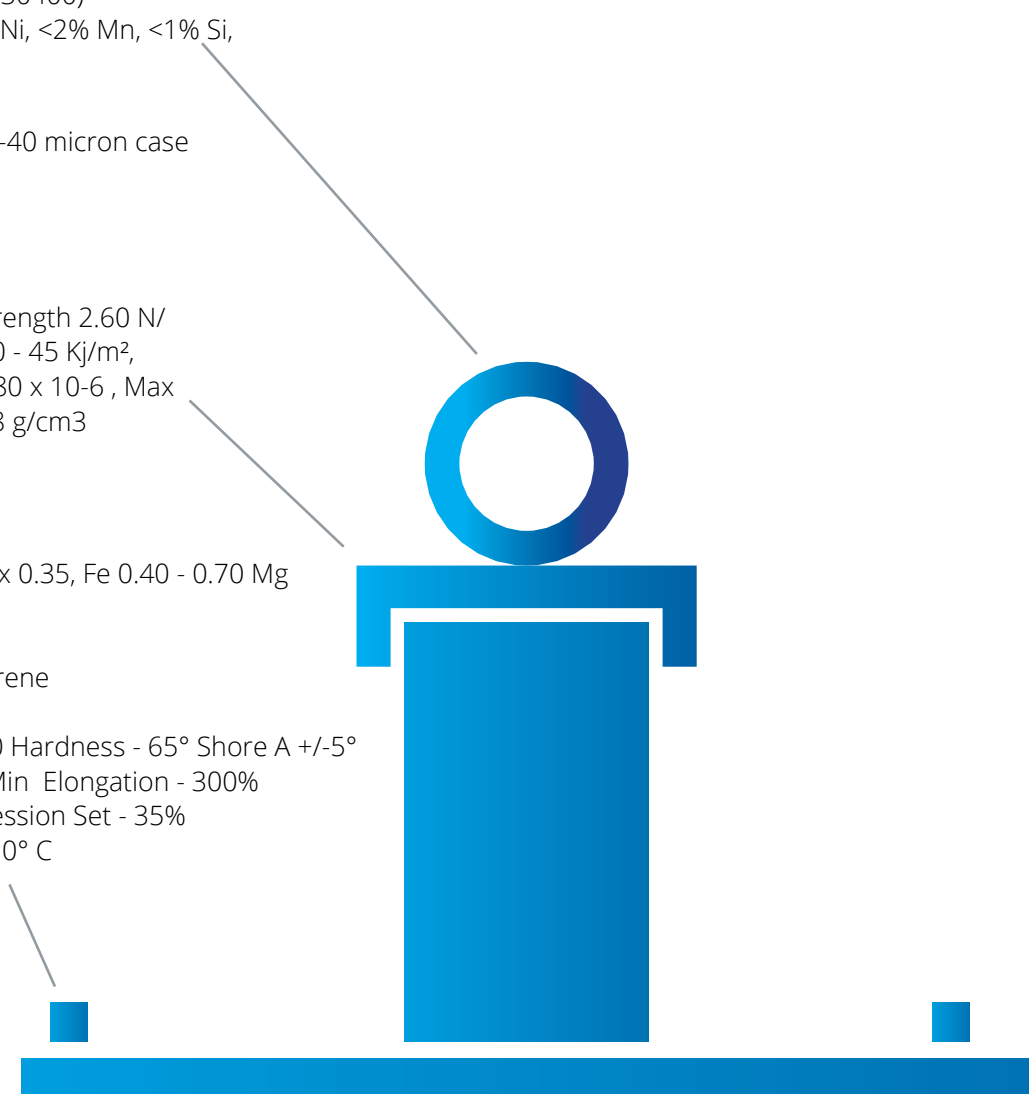

AVIATOR SECRET FIX ROOF SYSTEM



OPERATING AND DESIGN STANDARDS:

Eurocodes are designated by EN

British standards are designated by BS



- BS EN 795:2012 Class C – flexible safety lines
- BS EN 795:2012 Class A – single anchors, anti-pendulum anchors
- BS 7883: 2005 – Design, selection, installation, use and maintenance for anchors conforming to EN 795
- BSMA 29: 1982 – specification for steel wire rope
- ACR (M) 002:2009
- ACR (CP) 007:2008
- ISO 9001:2008
- ISO 14001:2004
- BS OHSAS 18001:2007
- Work at height regulations 2005 (Ref.7)
- Work at height (amendment) Regulations 2007 (Ref.8) WAHR
- Provision and use of work equipment regulations 1998 PUWER 98 (Ref. 5)
- PD CEN/TS 16415:2013 Multiple users

The company operates to the following standards



- Management of health and safety at work regulations 1999 MHSWR (Ref.2)
- The work at height safety association WAHSA guidance on inspecting eyebolts used for personal fall protection purposes

Typical connection loads (bracket height up to 150mm)

Ultimate factored load on bracket base



Bracket moment

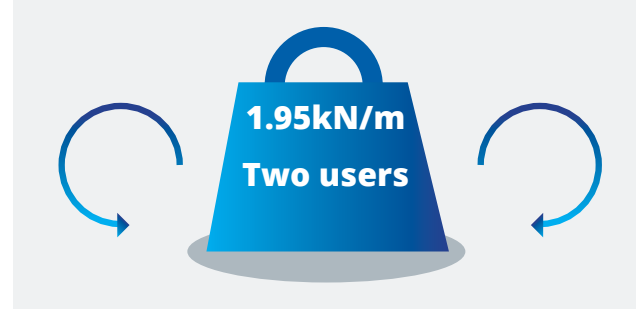

Note: For guidelines only to be checked by Chief Engineer.

INSPECTION/MAINTENANCE/TRAINING

INSPECTION ROUTINE:

All systems to be inspected at least every 12 months from date of installation.

In harsh environments all systems to be inspected at least every 3 months.

Inspections must be carried out by approved Aviator engineers.

Inspections must be approved to SIMS (Safety Inspection and Maintenance Service) standards.

All inspections to be carried out to EN795:2012 and BS 7883:2005 and WAHSA (inspection of eyebolts) requirements for safety line and anchor points.

All inspections to be carried out to EN364 requirements for personal protective equipment.

Contact Sayfa Systems to arrange inspections.

MAINTENANCE SCHEDULE:

All maintenance to be carried out by approved Aviator engineers. Maintenance to be in accordance with Sayfa Systems UK (manufacturer) guidelines and recommendations.

In harsh environments all systems to be inspected at least every 3 months.



Maintenance to be in accordance with SIMS standards. (details available on request)

Maintenance to be carried out at time of yearly inspection.

Contact Sayfa Systems to arrange system maintenance.



TRAINING REQUIREMENTS:

All personnel who use the Aviator system should have attended a Sayfa Systems Ltd, Aviator users course.

Courses are available from Sayfa Systems UK Ltd.

Courses cover the use of all Aviator and Payload products, the legal and practical side of the Working at Height legislation - 2005 and how to use and carry out safety checks on harnesses and all necessary PPE equipment.

CERTIFICATE

OF
OPERATIVE INSTRUCTIONAL TECHNIQUES AND
WORKING AT HEIGHT SAFETY

In recognition of successful completion of training for the installation and assembly, use, handling and safety checks of:-

Aviator Safety Line Systems	<input checked="" type="checkbox"/>
Aviator Mobile Anchors	<input type="checkbox"/>
Payload Access Ladder Systems	<input type="checkbox"/>
Payload Handrail Systems	<input type="checkbox"/>
Aviator PPE	<input checked="" type="checkbox"/>

To: _____

Location of Training: _____

Certificate Number: _____

Name of trainee: _____ Signed by trainee: _____

Instructor's name: Adrian Stutterheim..... Signed: *Adrian Stutterheim*.....

Date of Training: 00 January 1900

COMPONENT PART DETAILS:

End bracket SFB241

BIM No: SpecEquip_RfSftySymSecretFixEndBkt_SayfaSystems_SFB241_M3_G2



Intermediate bracket SFB242

BIM No: SpecEquip_RfSftySymSecretFixIntBkt_SayfaSystems_SFB242_M3_G2

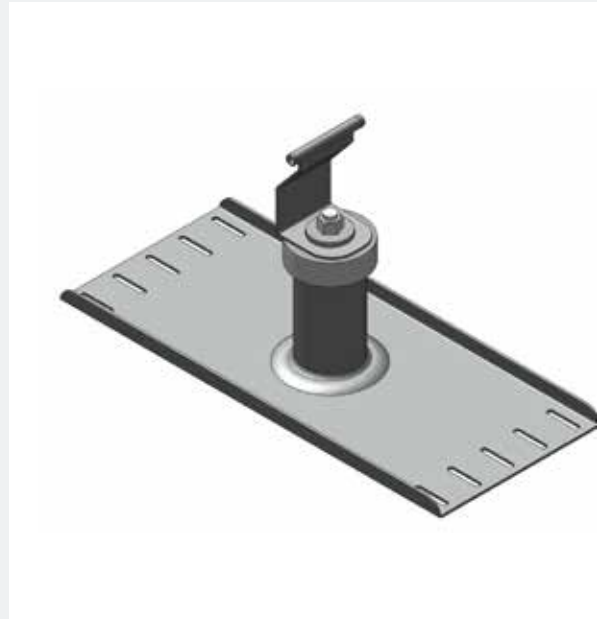

Corner bracket SFB243

BIM No: SpecEquip_RfSftySymSecretFixCornrBkt_SayfaSystems_SFB243_M3_G2

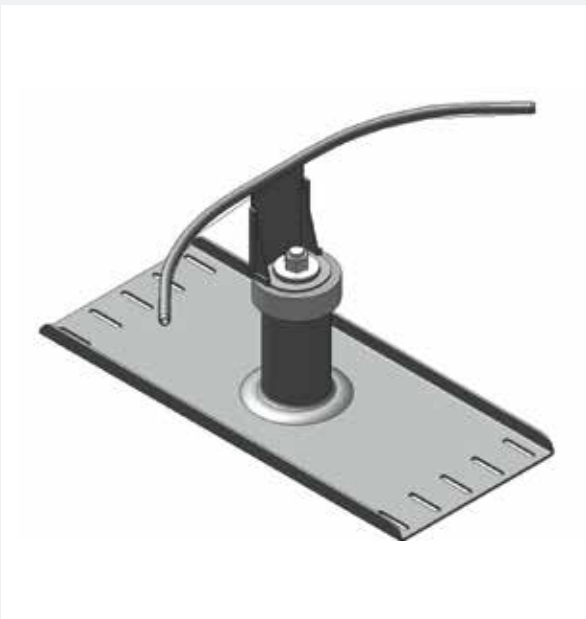

Bulbtype rivet BTR300

BIM No: SpecEquip_RfSftySymCompRvt_SayfaSystems_Btr300_M3_G2

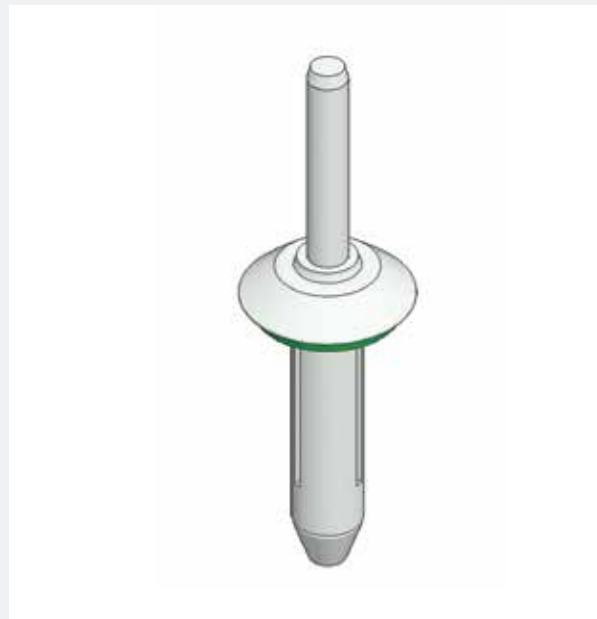

Aviator™ Secret Fix Roof System Fixed To Peaks With Clamps

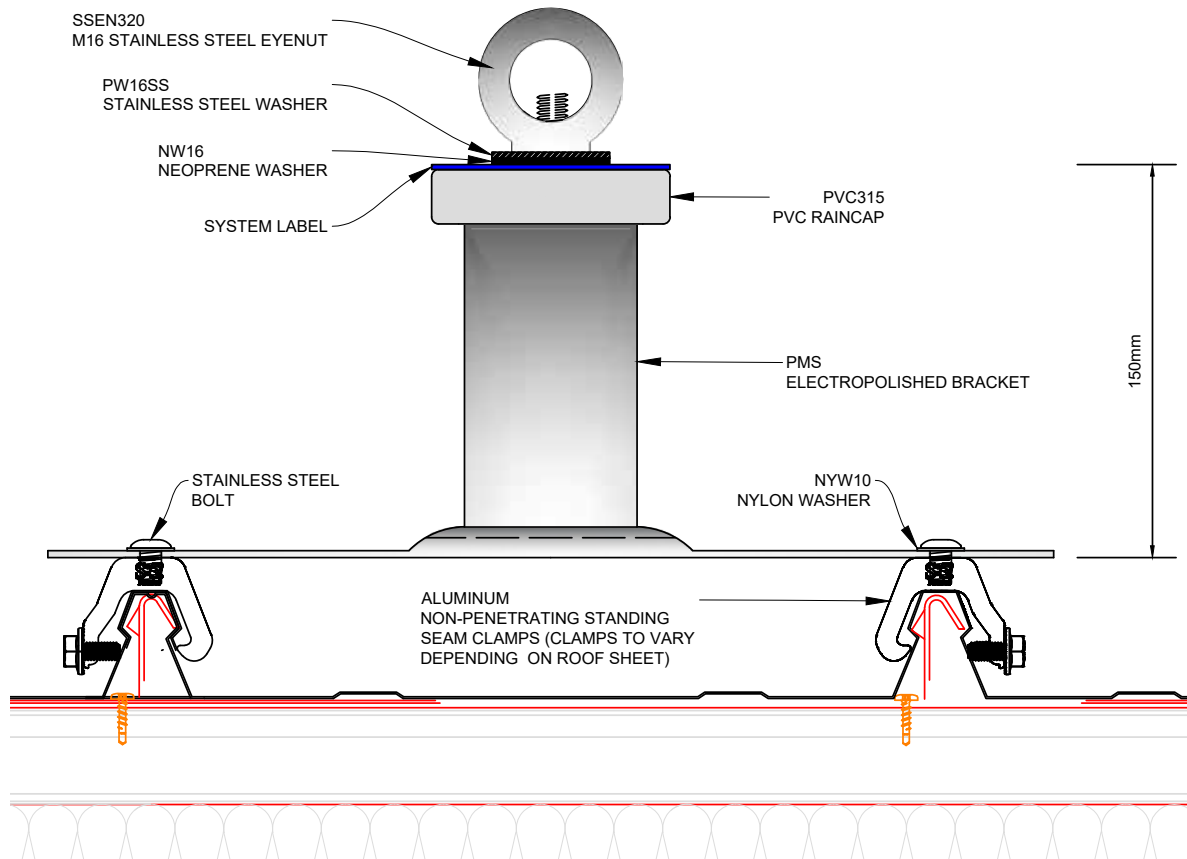

Aviator™ Secret Fix Roof System Fixed To Peaks With Rivets

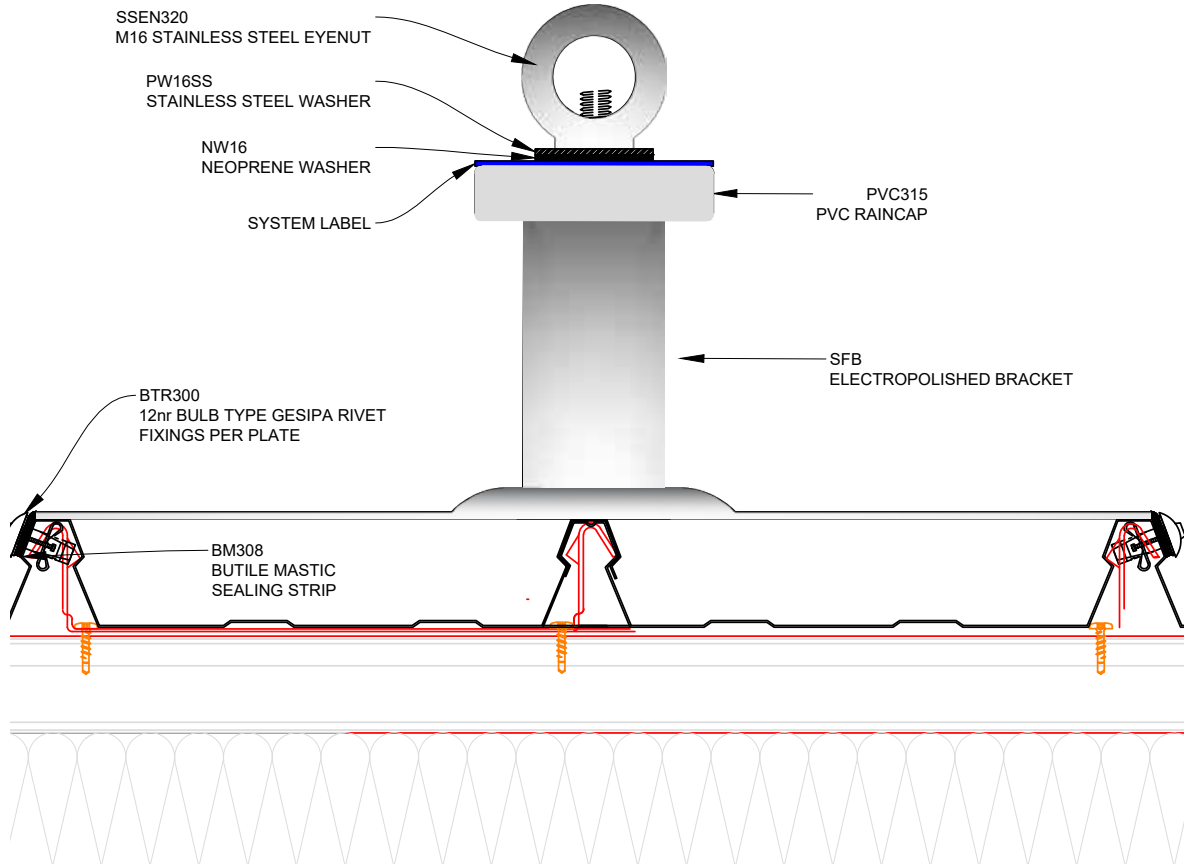

End Post for Profiled Metal - PMS251-430

SIDE VIEW (1 : 3)

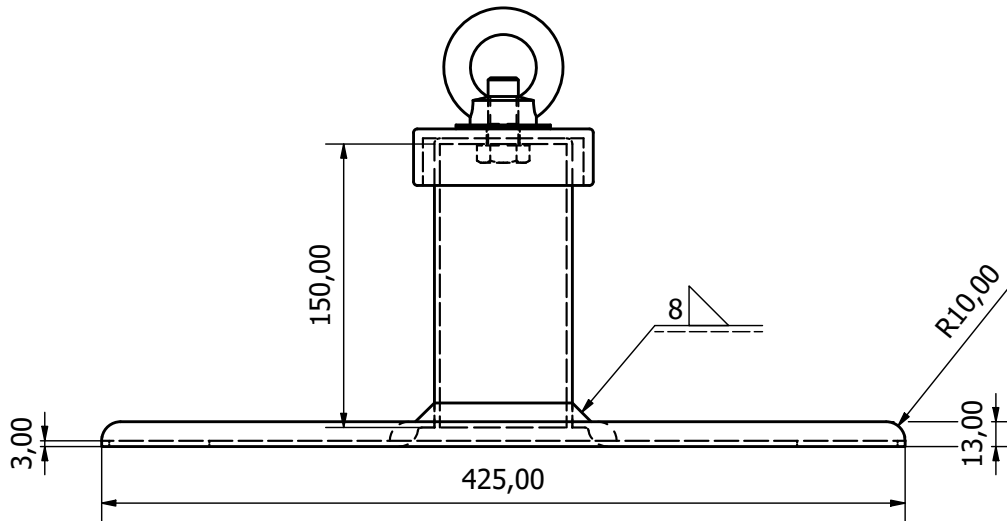

TOP VIEW (1 : 3)

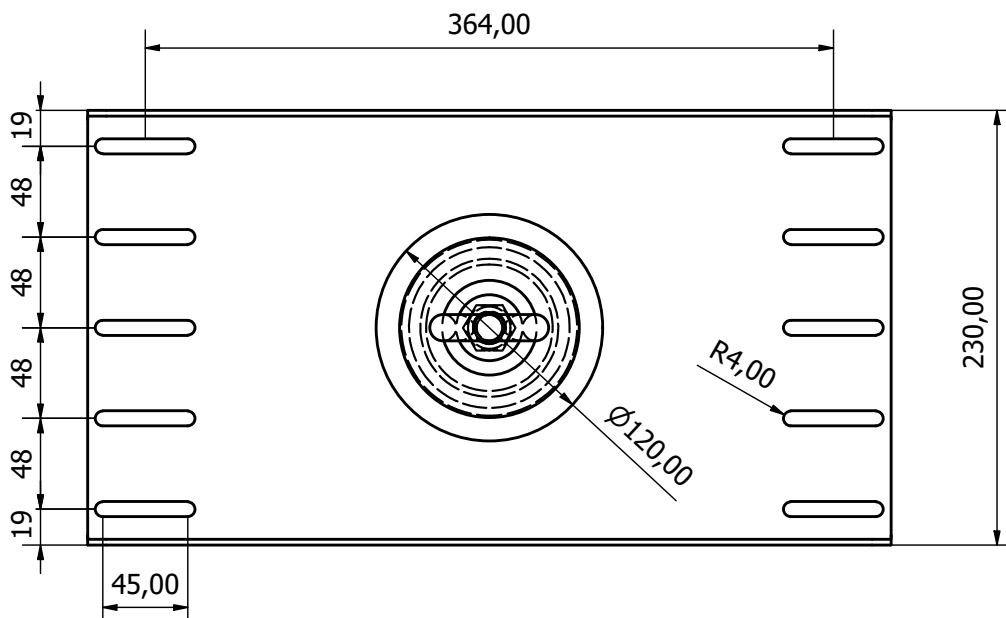

End Post for Profiled Metal - PMS251

SIDE VIEW (1 : 3)

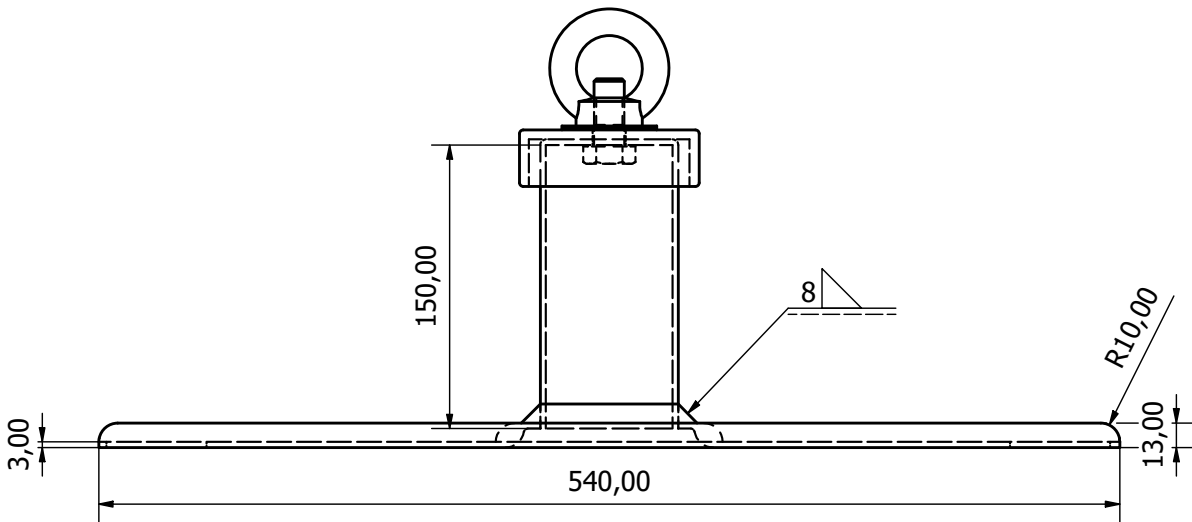

TOP VIEW (1 : 3)

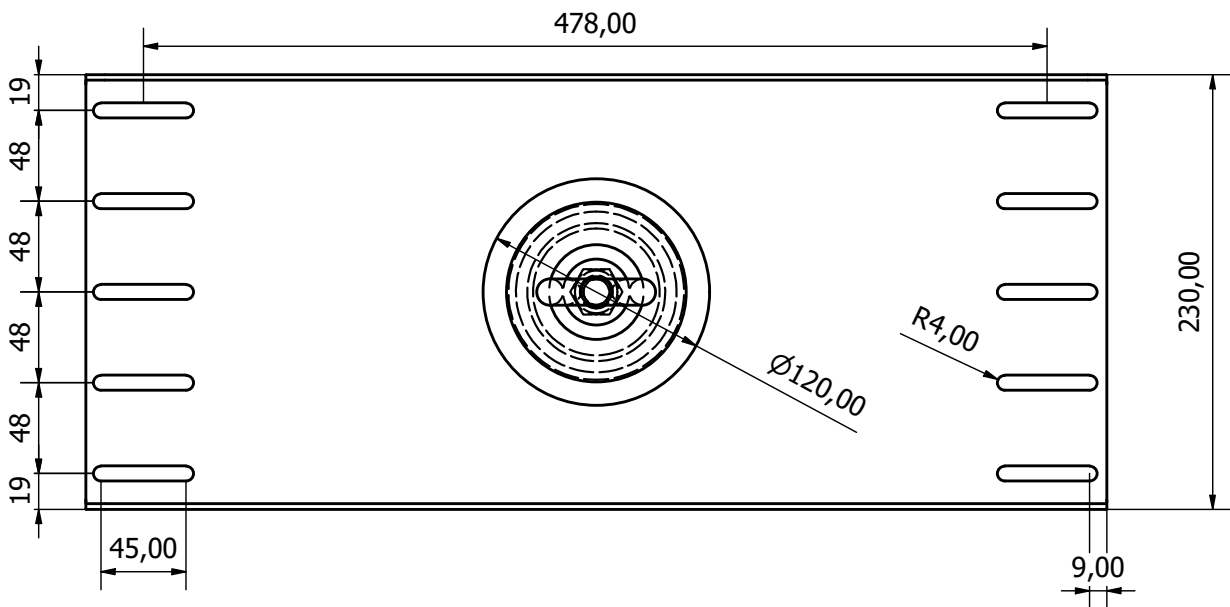



Sayfa Systems UK Ltd
Jubilee House
No. 3 Gelders Hall Road
Shepshed, Loughborough
Leicestershire LE12 9NH

T: 0845 241 9102
F: 0845 130 4520
email: info@sayfasystems.com
www.sayfasystems.co.uk